

## GENERAL SETTINGS

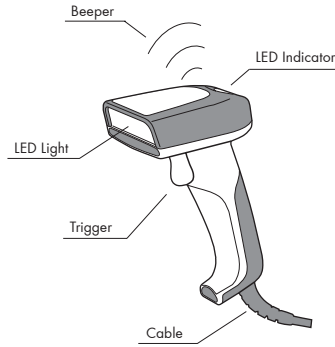

### LED Indication

- Off - Ready to scan or No power.
- Green - Good read or Bad read.
- Red - Error.

### Beeper

- Short Beep - Good read.
- 2 Beeps - Successful setup/ Power Up
- 5 Beeps - Error.

Note: The shape of scanner may vary based on configuration.

## QUICK INSTALLATION

### Step 1 - Connect to the host computer

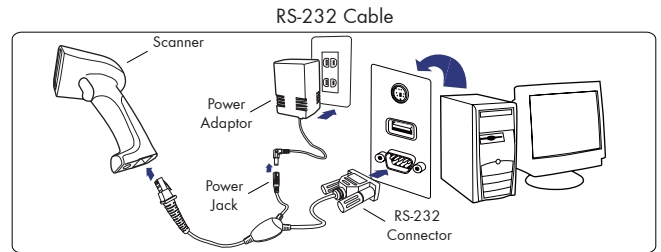
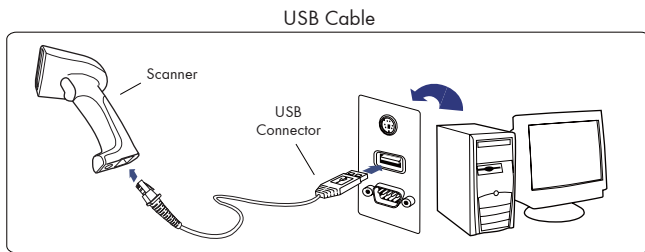

### Step 2 - Scan one of the barcodes below

#### USB CABLE - INTERFACE



**KEYBOARD HID**



**VIRTUAL COM**

#### RS232 CABLE - INTERFACE



**RS232**

### Step 3 - Now, you are ready!

If the scanner fails to decode your barcode, please start over by returning to Step 1.

## MISCELLANEOUS INSTRUCTIONS

### To change a cable

1. To release the cable, insert a pin or straightened paper clip into the hole at the base of the scanner where the cable is connected.
2. Remove the cable from the scanner.
3. Plug in the new cable.
4. Reset the interface by scanning the correct interface bar code (as in Interface).

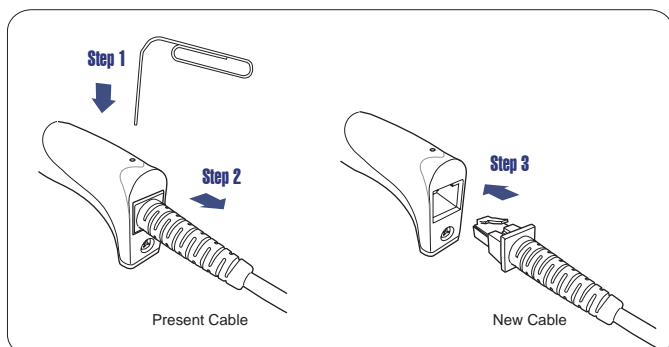

### Precautions during scanning

- Make the barcode label as flat as possible when it is distorted.
- The scanner may not read labels under direct sunshine or in extremely bright places.
- Reading of upside-down barcodes is possible.
- Take out the labels when it is covered with plastic films.

### Trouble Shooting

- Default:
  1. Please refer to Default.pdf(as on the Driver CD).
  2. Scan the correct interface barcode (as in Interface).
- The scanner does not scan when the trigger is pressed.
  1. Unplug the cable from the host computer.
  2. Plug the cable back into the host computer.
  3. Scan correct interface barcode (as in Interface).
- The Scanner reads correctly, except for certain barcode symbologies.
  - Enable the symbologies you are trying to scan (as in Enable Symbologies on the back page).
- For further advanced configuration options, please refer to the Driver CD.

# ADVANCED SETTINGS

The default settings are indicated in Bold and Underlined characters.

## READING MODE



CONTINUOUS MODE

\*The LED is always on.

\*The trigger does not function in Continuous Mode.



FLASH MODE

\*The LED is on steadily if a bar code is close to the scanner, but starts flashing if no bar code has been detected for 60 seconds.

\*The trigger does not function in Flash Mode.



**TRIGGER MODE**

\*The LED will light when the trigger is pressed.

\*The LED will go off when a bar code is decoded or the trigger is released.



TOGGLE MODE

\*The LED is always on after the trigger is pressed.

\*The LED will go off when a bar code is decoded or the trigger is pressed once again.



PRESENTATION MODE

\*The LED lights automatically when an object is detected.

\*The LED will go off if the scanner has not detected an object for 60 seconds.

## KEYBOARD LAYOUT



ENGLISH (USA)



ITALIAN



GERMAN



ENGLISH (UK)



CZECH (QWERTY)



SWISS GERMAN



FRENCH



JAPAN (106 KEYS)



HUNGARIAN



UNIVERSAL CODE



SPANISH

## CENTER DECODING

Only decode the bar code that laser aimer is aimed at.



CENTER DECODING ON



CENTER DECODING OFF

# REGULATORY INFORMATION

### Federal Communication Commission Interference Statement

This equipment has been tested and found to comply with the limits for a Class B digital device, pursuant to Part 15 of the FCC Rules. These limits are designed to provide reasonable protection against harmful interference in a residential installation.

This equipment generates, uses and can radiate radio frequency energy and, if not installed and used in accordance with the instructions, may cause harmful interference to radio communications. However, there is no guarantee that interference will not occur in a particular installation. If this equipment does cause harmful interference to radio or television reception, which can be determined by turning the equipment off and on, the user is encouraged to try to correct the interference by one of the following measures:

- Reorient or relocate the receiving antenna.
- Increase the separation between the equipment and receiver.
- Connect the equipment into an outlet on a circuit different from that to which the receiver is connected.
- Consult the dealer or an experienced radio/TV technician for help.

FCC Caution: To assure continued compliance, any changes or modifications not expressly approved by the party responsible for compliance could void the user's authority to operate this equipment. (Example - use only shielded interface cables when connecting to computer or peripheral devices).

### FCC Radiation Exposure Statement

This equipment complies with FCC RF radiation exposure limits set forth for an uncontrolled environment. This equipment should be installed and operated with a minimum distance of 20 centimeters between the radiator and your body.

This transmitter must not be co-located or operating in conjunction with any other antenna or transmitter.

The antennas used for this transmitter must be installed to provide a separation distance of at least 20 cm from all persons and must not be co-located or operating in conjunction with any other antenna or transmitter.

This device complies with Part 15 of the FCC Rules. Operation is subject to the following two conditions:

- (1) This device may not cause harmful interference, and (2) This device must accept any interference received, including interference that may cause undesired operation.

## ENABLE SYMBOLOGIES



CODE 11



INDUSTRIAL 2 OF 5



GSI DATABAR - OMNI-DIRECTIONAL



CODE 128



GSI DATABAR - EXPANDED



CODE 32



INTERLEAVED 2 OF 5



CODE 39



MATRIX 2 OF 5



CODE 93



EAN-128/ GS1-128



CODABAR



EAN-8



IATA



EAN-13



MSI CODE



UPC-A



PLESSEY CODE



UPC-E



TELEPEN



CHINA POST



AZTEC



GSI DATABAR - LIMITED



DATAMATRIX



MAXICODE



MICROPDF417



PDF417



QR CODE



DISABLE ALL SYMBOLOGIES

## TERMINATOR



SPACE



CR+LF



NONE



TAB



CR



LF

WARNING		<ul style="list-style-type: none"> <li>• Take any metals into contact with the terminals in connectors.</li> <li>• Use the scanner where any inflammable gases.</li> </ul>
		<p>If following condition occur, immediately power off the host computer, disconnect the interface cable, and contact your nearest dealer.</p> <ul style="list-style-type: none"> <li>• Smoke, abnormal odors or noises come from the scanner.</li> <li>• Drop the scanner so as to affect the operation or damage its housing.</li> </ul>
CAUTION		<p>Do not do behavior below.</p> <ul style="list-style-type: none"> <li>• Put the scanner in places excessively high temperatures such as expose under direct sunlight.</li> <li>• Use the scanner in extremely humid area or drastic temperature changes.</li> <li>• Place the scanner in oily smoke or steam environment such as cooking range.</li> <li>• Be covered or wrapped up the scanner in bad-ventilated area such as under cloth or blanket.</li> <li>• Insert or drop foreign materials or water into scanning window or vents.</li> <li>• Using the scanner while hand is wet or damp.</li> <li>• Use the scanner with anti-slip gloves containing plasticizer and chemicals or organic solvents such as benzene, thinner, insecticide etc to clean the housing. Otherwise, it could not result fire and electrical shock but housing may be broken and injured.</li> <li>• Scratch or modify the scanner and bend, twist, pull or heat its interface cable.</li> <li>• Put heavy objects on interface cable.</li> </ul>
		<p>Do not stare the light source from the scanning window or do not point the scanning window at other people's eyes or eyesight may be damaged by direct exposure under the light.</p>
		<ul style="list-style-type: none"> <li>• Do not put the scanner on an unstable or inclined plane. The scanner may drop, creating injuries.</li> </ul>
		<p>Once the interface cable is damaged such as exposed or broken copper wires, stop using immediately and contact your dealer. Otherwise, it could result fire or electrical shock.</p>